

TECHNICAL DATA

Body Type	Line mount
Interface	None
Body Features	Through port 2 with gauge port
Mounting Hole Thread	M10x1.5 - 6H
Mounting Hole Depth	15,7 mm
Mounting Hole Quantity	2
Open Cavities	1
Cavity	T-11A
Port Size	1/2" BSPP
Model Weight	0.74 kg.

NOTES

Important: Carefully consider the maximum system pressure. The pressure rating of the manifold is dependent on the manifold material, with the port type/size a secondary consideration. Manifolds constructed of aluminum are not rated for pressures higher than 3000 psi (210 bar), regardless of the port type/size specified.

PORT DESIGNATORS

Modifiers	Ports
WSD	Ports 1 & 2: 1/2" BSPP; Port 3: 3/8" BSPP; Gage Port: 1/4" BSPP;

CONFIGURATION OPTIONS

Model Code Example: WSD

MODIFIER

6061-T651 Aluminum, Buna-N
/S 65-45-12 Ductile Iron, Buna-N, Blackened

MANIFOLD FACES

FACE GRID

1	2	3	4
5	6	7	8
9	10	11	12

Face 2

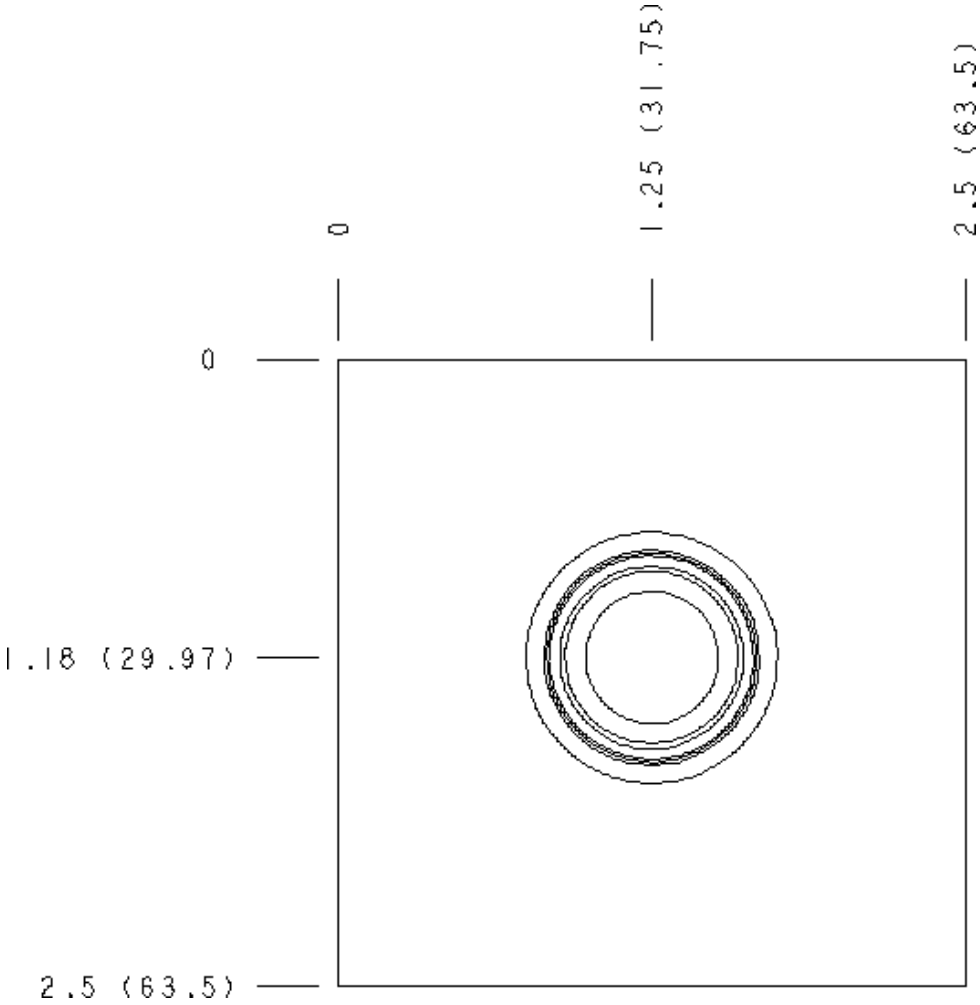

Face 5

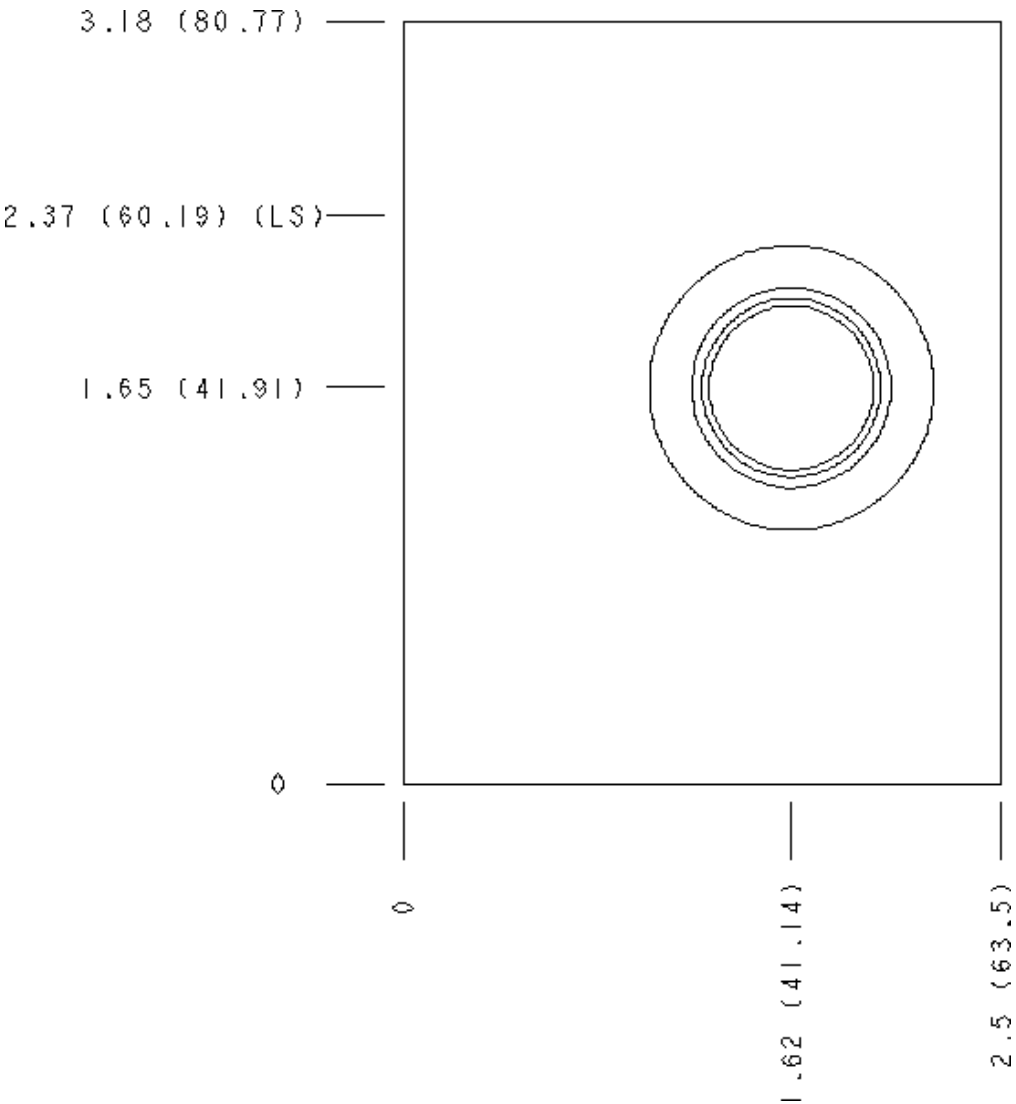

Face 6

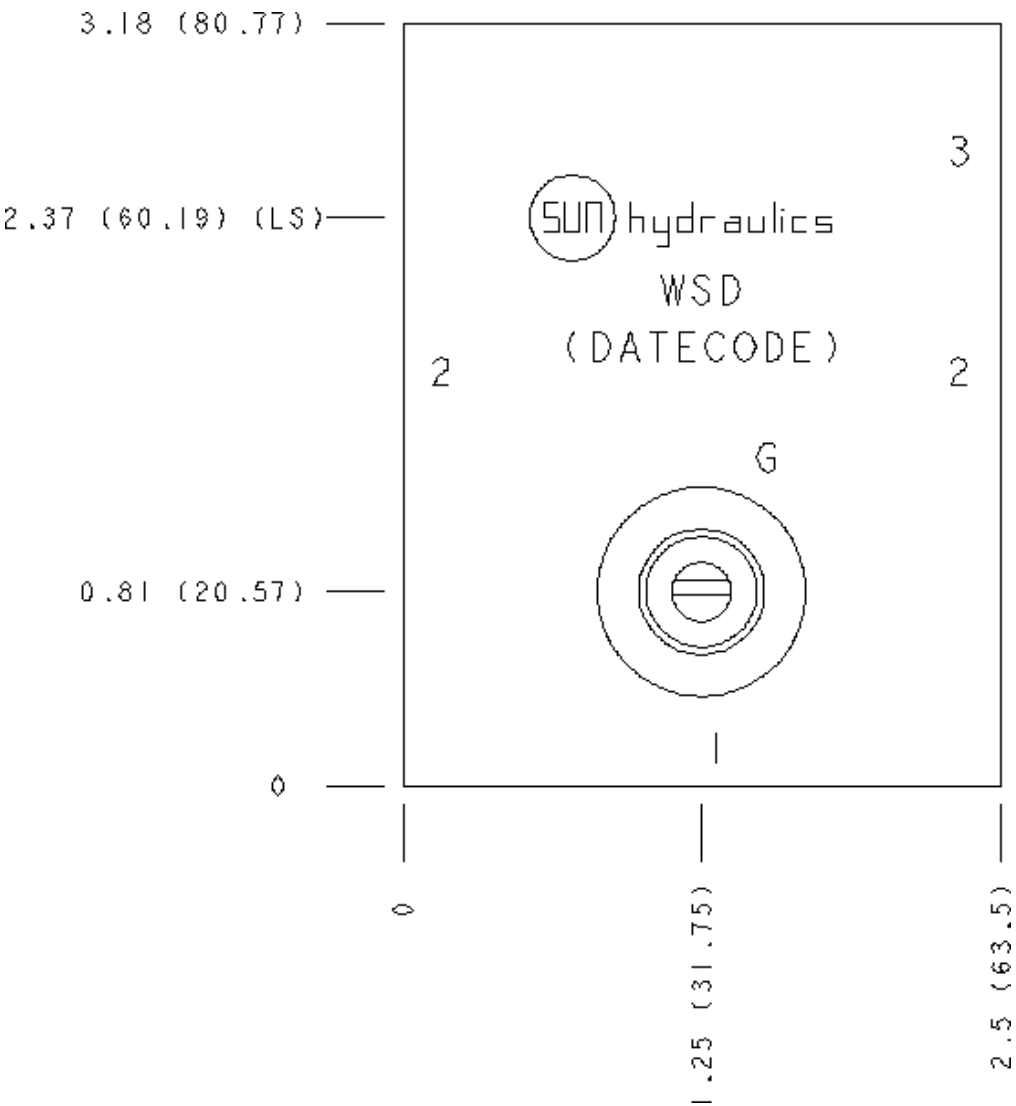

Face 7

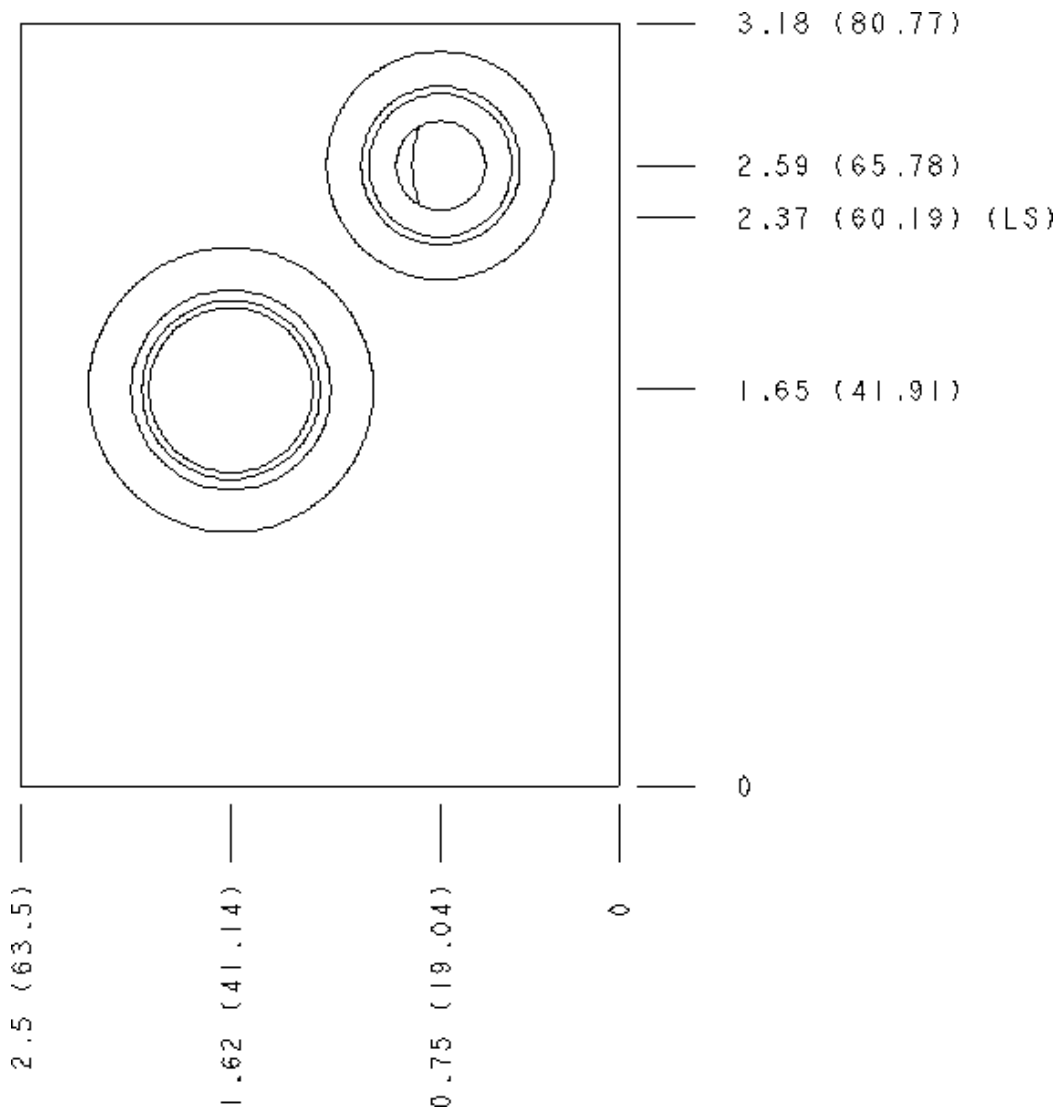

Face 8

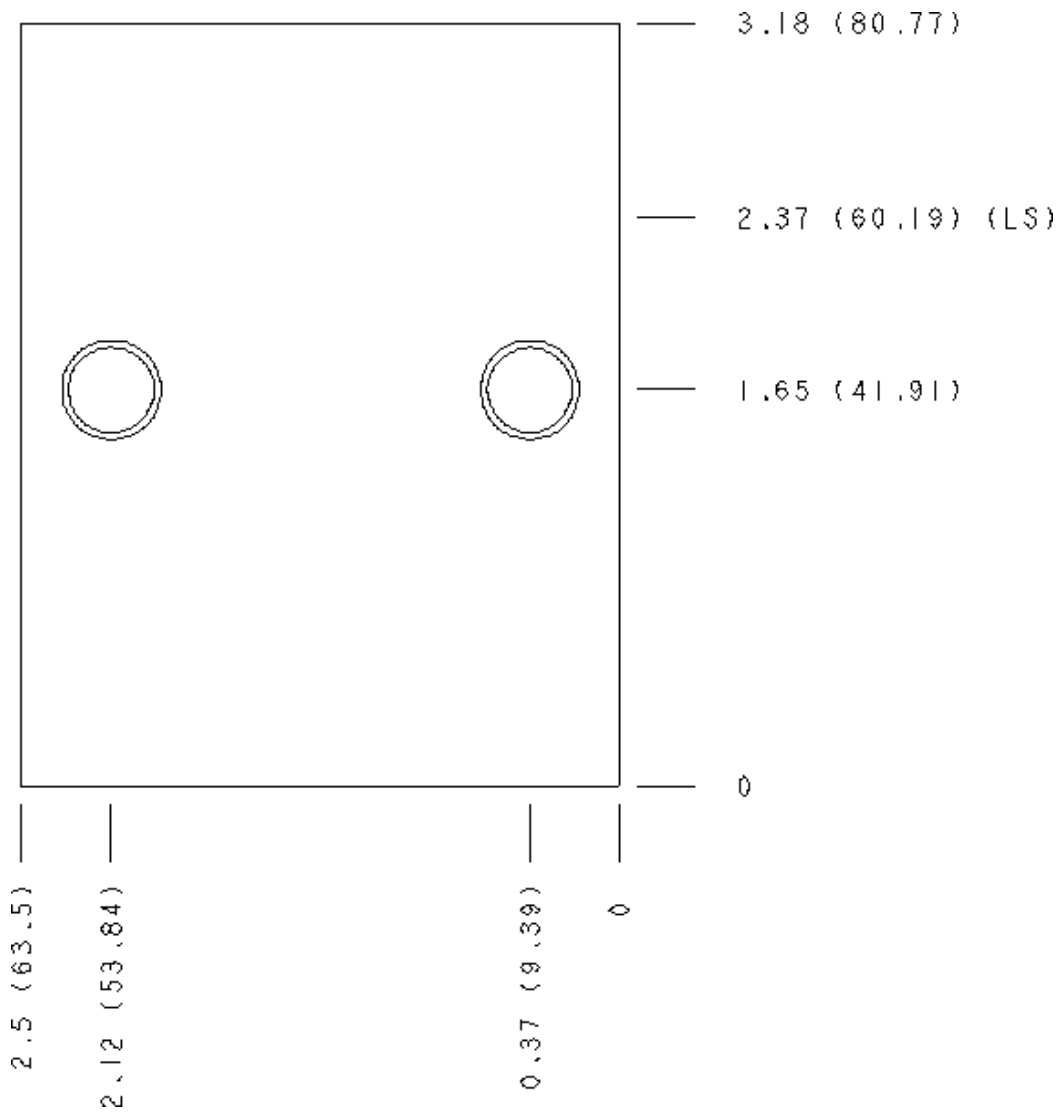

Face 10

