

DC COIL

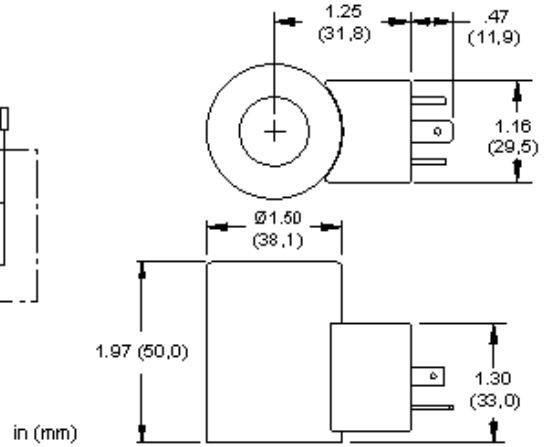

TECHNICAL DATA

Maximum Coil Temperature at 68°F (20°C) Ambient	218°F (105°C)
Arc Suppression (TVS)	Included
Power Consumption (cold) - at rated voltage	22 watts
Maximum Ambient Temperature	50 °C
Voltage/Frequency	28 VDC
Operating Voltage Range	+/- 10% nominal
Duty Cycle Rating	100 %
Connector	ISO4400 - EN/DIN175301-803, Form A (ISO/DIN 43650) 3-pin
Connector Environment Rating	IP65/IP67
Solenoid Tube Diameter	19 mm
Coil Nut Torque	0,5 Nm
Model Weight	0.23 kg.

USED WITH

DAAL	DAALS	DBAL	DBALS	DFCA	DFCB	DFDA	DFDB	DFEA	DFEB
DFFA	DFFB	DLDA	DLDAS	DLDAZ	DMDA	DMDAS	DMDAZ	DNCA	DNCAZ
DNDA	DNDAS	DNDC	DNDY	DNDYS	DTCA	DTCAZ	DTDA	DTDAS	DWDA

TECHNICAL FEATURES

- Coil windings utilize Class N, (392° F [200 °C] rated) magnet wire.
- A TVS surge suppression diode is built into DC coils. Nominal breakdown voltage: 68V. Model code 1.5 KE68CA Steady state power dissipation @ 75°C is 6.5 W and peak pulse dissipation is 1500 W for 1 ms, nonrepetitive.
- Power cable with mating connector is required and is not included with product.
- This coil is CE compliant. It meets the requirements of the Low Voltage Directive (2006/95/EC) and EN 60204-1:2006.
- The coil is magnetically symmetrical and can be mounted in either direction on the solenoid tube without affecting performance.
- IP rating is dependent on the coil connector and the mating connector used.
- RoHS compliant. Restricted materials less than 0.1% total by weight.
- The external steel shell is zinc plated with black dichromate.